

## PE6V4.5F1



### Specifications

Nominal Voltage	6 V
Rated Capacity (20 hour rate)	4.5 Ah
Weight	1.96 lbs. (0.89 kg)
Case Material	Synthetic Resin (ABS)

### Dimensions

Length	2.76 inch (70.0mm)
Width	1.85 inch (47.0mm)
Height	4.02 inch (102.0mm)
Total Height	4.17 inch (106.0mm)

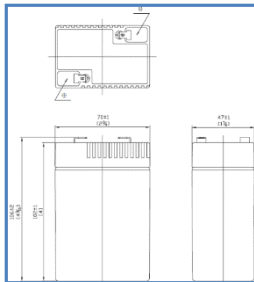

**Standard Terminal**  
F1 : AMP Fasten  
Type 187

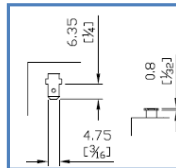

### Characteristics

Energy Density	1.32 Watt-hours/cubic inch
Specific Energy	13.8 Watt-hours/pound
Maximum Discharge Current with Standard Terminals	27 A
Maximum Short Duration Discharge Current	67.5 A (less than 5 sec.)
Vibration Test	No Loss Capacity or Performance (2000 cycles/minute, 0.10 excursion, 2 hours)
Charge Retention (Shelf Life)	% of Nominal Capacity at 77°F (25°C) 1 month 97% 3 month 90% 6 month 80%
Recommended Ambient Temperature Range	Charge : 32°F (0°C) to 104°F (40°C) Discharge : -4°F (-20°C) to 122°F (50°C) Storage : -4°F (-20°C) to 104°F (40°C)
Internal Resistance of Fully Charged Battery	35 Milliohms

### Charging

Recommended Charging Methods	<b>CYCLE USE :</b> Maximum Initial Charge Current : 1.125A Charging Voltage : 7.20 ~7.35V Charge Should Be Switched to Float Mode or Disconnected When Current Drops to 45mA
	<b>STANDBY USE (Float) :</b> Maximum Initial Charge Current : 1.125A Charge Voltage : 6.75 ~6.90V

End of Discharge Voltage		Discharge Time										
		10M	15M	30M	1H	2H	3H	4H	5H	8H	10H	20H
5.40V	W	54.37	40.71	23.65	14.12	8.33	6.04	4.87	4.07	2.76	2.31	1.27
	A	8.95	6.76	3.88	2.31	1.37	0.99	0.80	0.67	0.45	0.38	0.22
5.25V	W	56.89	42.69	24.42	14.59	8.61	6.23	5.02	4.20	2.85	2.38	1.32
	A	9.42	7.09	3.99	2.37	1.42	1.02	0.83	0.69	0.47	0.39	0.23
5.10V	W	59.67	44.61	25.18	15.04	8.87	6.42	5.18	4.32	2.94	2.46	1.36
	A	9.84	7.38	4.11	2.44	1.46	1.05	0.85	0.71	0.48	0.40	0.23
4.80V	W	64.32	47.58	26.74	15.99	9.41	6.83	5.50	4.58	3.12	2.61	1.44
	A	10.61	7.85	4.38	2.62	1.56	1.12	0.90	0.75	0.51	0.43	0.25